

# TBR30 BLADDER ACCUMULATORS 1 QUART

Model Number	Gas Capacity		Fluid Capacity		Dry Weight		Dimension C		Dimension D		Dimension E
	In. <sup>3</sup>	Cm. <sup>3</sup>	Gallon	Liters	Lbs.	Kg.	Inch	mm	Inch	mm	
TBR30-.2NMD	73	1196	.25	1	10	5	2.125	54	1.625	41	SAE-16 STANDARD 1" NPT OPTIONAL TO SPECIFY 1" NPT, REPLACE "D" WITH "6"

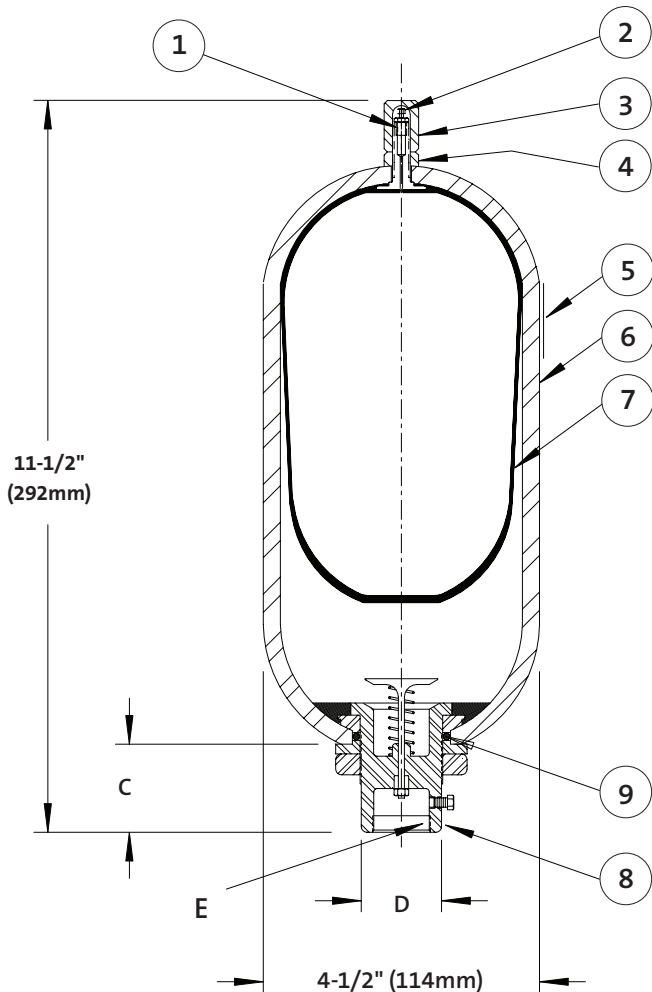

Item Number	Part Number	Description	Number Required
1	3A-185	Core, Gas Stem	1
2	3A-190	Cap, Gas Stem	1
3	TB-208-PC	Guard, Gas Valve, 1 Quart	1
4	TB-218	Lock Nut, Adaptor, Zinc Plated	1
5	NP-100	Nameplate	1
6	TB30-50	Shell (Not Available Separately)	1
7	BB30-.2*	Bladder	1
8	TB-G930	Quart Oil Port Body Assm - SAE-16	1
Opt.	TB-G930-P	Quart Oil Port Body Assm - 1" NPT	Opt.
9	SB2T28	Seal, Backup, Teflon	1

Specify bladder and seal material by selecting appropriate material code: "N" = BUNA-N, "B" = BUTYL, "E" = EPR, "V" = FKM (Viton®)

## Complete repair kits for Bottom Repairable Models — 2.5, 5, 10, 11 and 15 gallons

New Part Number	Type	Old Part Number
BK30-.2N	BUNA-N	RB30-.2NT
BK30-.2V	FKM (Viton®)	RB30-.2ET
BK30-.2B	BUTYL	RB30-.2BT
BK30-.2E	EPR	RB30-.2HT

Repair kit includes: (1) Bladder, (1) Gas Valve & O-Ring, (2) Oil Port Body O-Ring, and (2) O-Ring Backup and (1) Anti-extrusion Ring.

Maximum working pressure 3,000 psi (207 bar)  
 Maximum proof pressure 4,500 psi (310 bar)  
 Minimum burst pressure 12,000 psi (827 bar)

Operating temperature (BUNA/Nitrile)  
 -20° to +200°F (-28° to 93°C)

Bladder for petroleum base oil. Shell ASME "U" stamped.  
 Appendix 22 MAWP 4,000 psi (276 bar).  
 Interchangeable with most other brands.

TOBUL ACCUMULATOR INCORPORATED

[www.fst.com](http://www.fst.com)